

# MCX Signal Conductor Jack

up to 2 GHz  
(50 Ω)

HFS-810 / HFS-810 M  
HFS-410 / HFS-410 M

Series:

Available  
Tip Styles:

Ordering Description:

HFS-810 ...

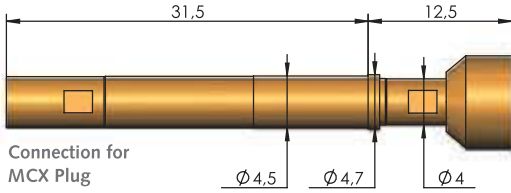

HFS-810 ... M (\*)



HFS-410 ...

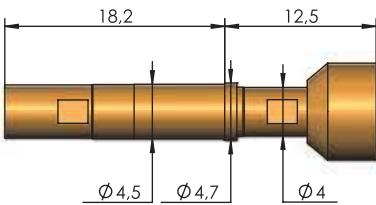

HFS-410 ... M (\*)

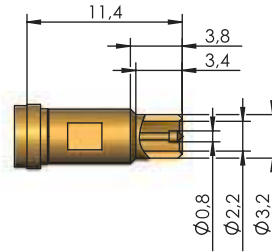
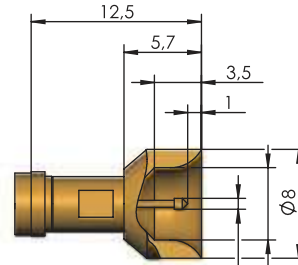
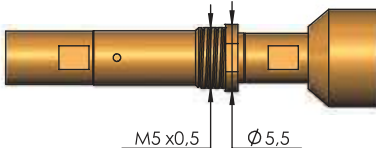

HFS-810 308 080 A **xx** 43 X  
HFS-810 308 080 A **xx** 43 X M  
HFS-410 308 080 A **xx** 43 X  
HFS-410 308 080 A **xx** 43 X M

**Note:** Version with enlarged centering range. Outer conductor centers itself from the outer side on the Connector.  
Centering range: ± 1.4 mm

HFS-810 308 080 A **xx** 42 X4  
HFS-810 308 080 A **xx** 42 X4 M  
HFS-410 308 080 A **xx** 42 X4  
HFS-410 308 080 A **xx** 42 X4 M

**Note:** Version with pre-centering on the inner side of the Connector Outer Contact.  
Centering range: ± 0.6 mm

### Spring force rating

The spring-loaded Inner and Outer Conductors are available with different spring forces. The ordering description is derived by adding up the individual values.

	HFS-810 HFS-810 M				HFS-410 HFS-410 M
Spring Force of Inner Conductor (N)	1.3	2.0	1.3	2.0	1.0
Spring Force of Outer Conductor (N)	4.0	6.0	8.0	8.0	4.0
Character for ordering	<b>53</b>	<b>80</b>	<b>93</b>	<b>99</b>	<b>50</b>

### Note: (\*)

For usage in the case of vibration, shaking, snapping or assembly upside down.

### Mechanical Data

HFS-810 and HFS-810 M

	Outer Cond.	Inner Cond.
Working Stroke:	4.0 mm	2.0 mm
Maximum Stroke:	5.0 mm	3.7 mm

### Mechanical Data

HFS-410 and HFS-410 M

	Outer Cond.	Inner Cond.
Working Stroke:	2.0 mm	2.0 mm
Maximum Stroke:	3.0 mm	3.0 mm